

***f.a.l.***

# **SCENE PRO 1000**

## **Instruction Manual**

model:

PF 6307      SCENE PRO 1000 ASYMMETRICAL

PF 6308      SCENE PRO 1000 SYMMETRICAL

### **ATTENTION**

This instruction manual contains important information about the installation and use of the projector. Please read and follow these instruction carefully.

### **ATTENTION**

Always ensure that the power to the projector is disconnected before opening the projector or commencing any maintenance work.



## INDEX

01 – SAFE USAGE OF THE PROJECTOR .....	3
02 – INSTALLING THE PROJECTOR.....	3
03 – FITTING THE LAMP.....	4
04 – POWER SUPPLY MAINS.....	4
05 – FILTER FRAME .....	5
06 – MAINTENANCE .....	5
07 – DIMENSIONS.....	5

---

Please note that as part of F.A.L.'s ongoing commitment to continuous product development, specifications are subject to change without notice. Whilst every care is taken in the preparation of this manual F.A.L. reserves the right to change specifications in the course of product improvement. The publishers cannot be held responsible for the accuracy of the information herein, or any consequence arising from them.

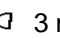
## 01 – SAFE USAGE OF THE PROJECTOR

- ✓ Do not attempt to dismantle and modify the projector.
- ✓ Do not allow contact with water or any other fluids, or metallic objects (IP 20).
- ✓ Do not install the projector in areas of high humidity.
- ✓  Not allowed to be mounted directly on inflammable surfaces.
- ✓ Keep at least 0.5m distance between the projector and adjacent inflammable surfaces.
- ✓ The lighting apparatus must be used only with its protective shield.
- ✓ Protective shields, lens, U.V. filters should be replaced if visibly damaged by grooves or fissures that lower their efficiency.
- ✓ The lamp must be replaced if it becomes damaged or deformed by heat.
- ✓  3 m  Keep at least 3m between the lamp and the illuminated surfaces.
- ✓ Avoid direct exposure to the light from the lamp. The light is harmful to the eye.
- ✓ Note:- The lamp reaches very high temperatures, allow at least 10 minutes for the lamp to cool completely before attempting to handle it.
- ✓ Use only F.A.L. original spare parts.

## 02 – INSTALLING THE APPARATUS

The projector should be mounted through the 11mm hole (1) in its bracket. For safety, the projector should have a secondary fixing with a safety chain through the fixing eye (3). The projector bracket allows an angle adjustment of  $\pm 90^\circ$  and, once positioned, the knob (2) should be firmly tightened.

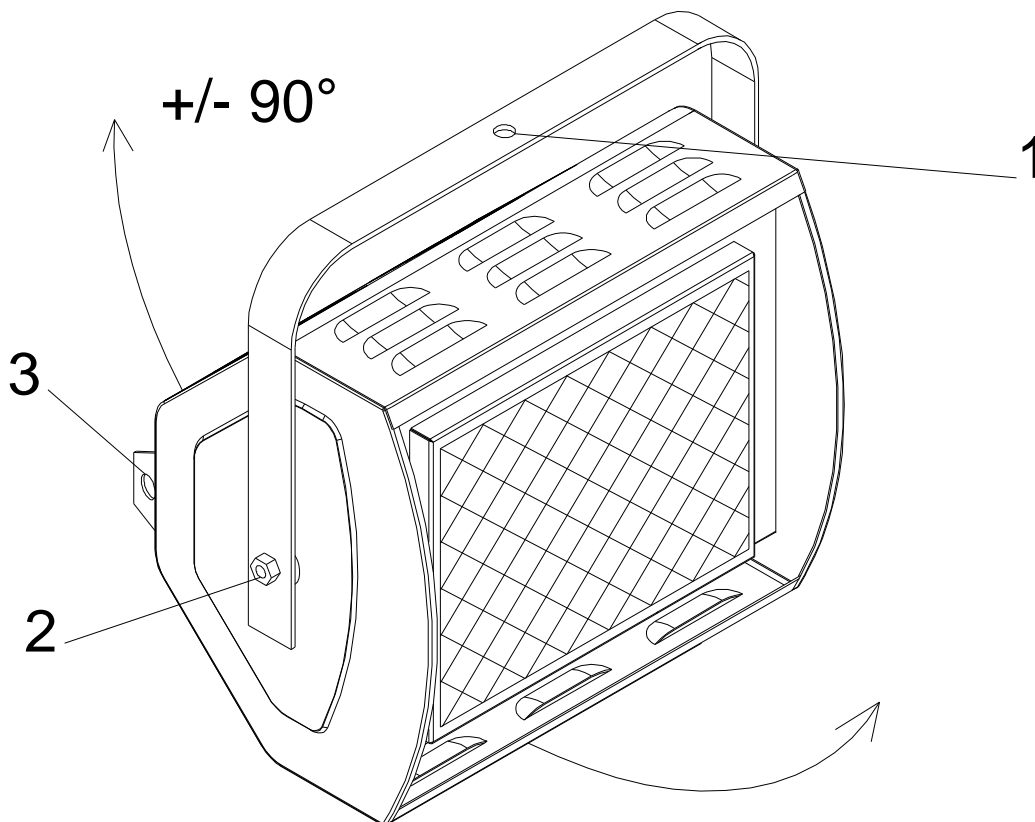

### 03 – FITTING THE LAMP

The lamp access hatch is released by turning the screw (4). Open the protective grill and insert the P2/7 (or K4) 1000W lamp into its socket. (Use only the lamp version that is correct for the mains voltage 120V/220V/240V). Insert the lamp with care and without using excessive force; use a cloth to hold the lamp and do not touch the glass of the lamp directly with your hands. Replace the protective grill and close the access hatch.

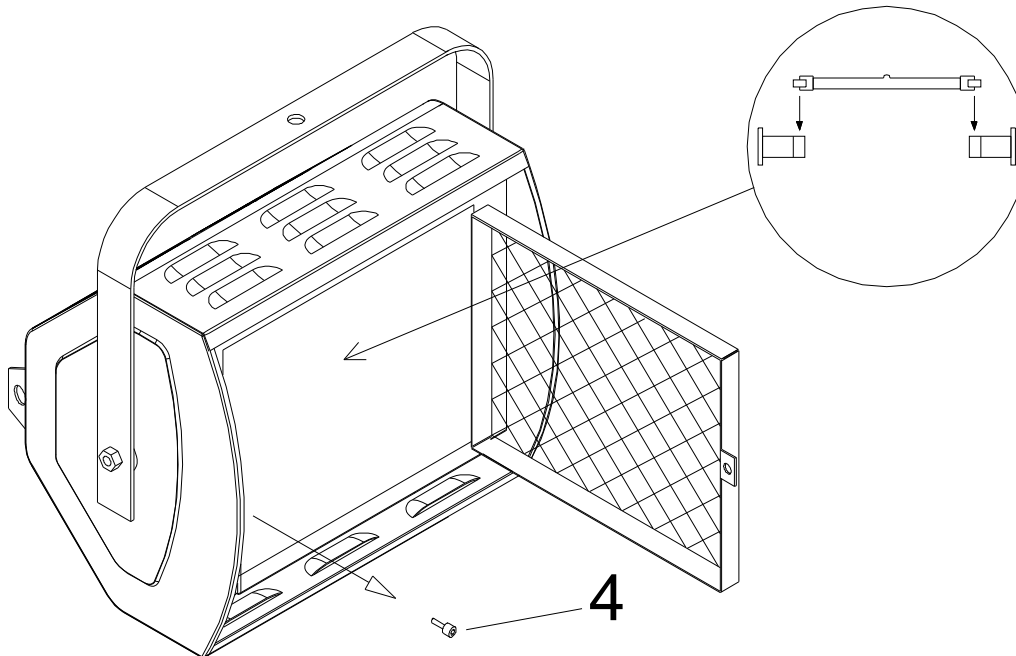

### 04 – POWER SUPPLY MAINS

Use the plug provided to connect the mains power to the projector paying attention to the voltage and frequency marked on the panel of the projector. It is recommended that each projector is supplied separately so that they may be individually switched on and off.

It is essential that each projector is correctly earthed and that electrical installation conforms to all relevant standards.

The blue wire is neutral (N), the brown wire is live (L), and the yellow-green wire is earth (E).

L = Brown
E = Yellow / Green
N = Blue

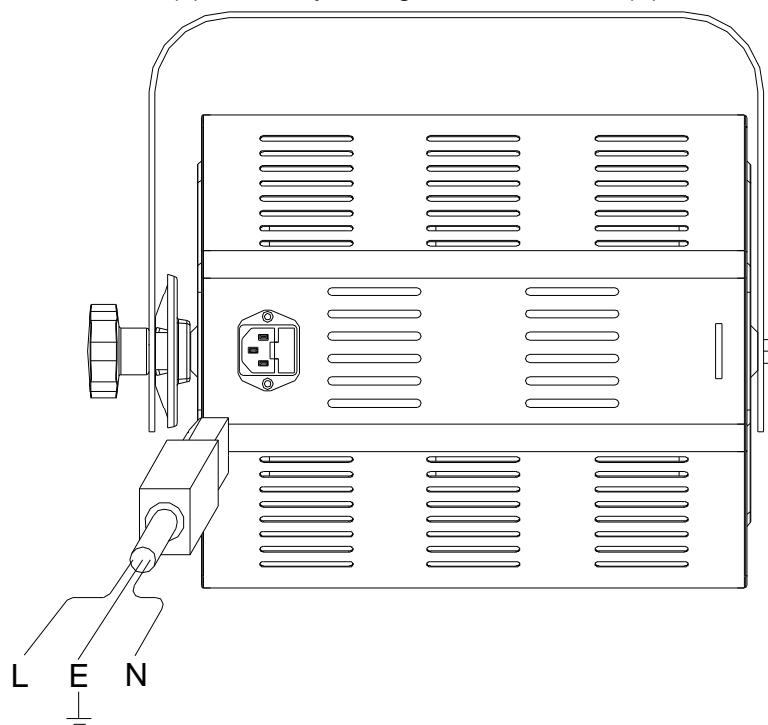

## 05 – FILTER FRAME

The filter frame is located in the front of the projector. Slide the filter frame out and insert the coloured gel. Replace when the gel is inserted.

## 06 – MAINTENANCE

If the protective grill becomes damaged it should be replaced.

If the lamp becomes damaged or deformed in any way it must be replaced.

Clean the reflector and the glass periodically (at least every six months) to maintain optimum light output from the unit.

Use only F.A.L. original spare parts.

## 07 – DIMENSIONS

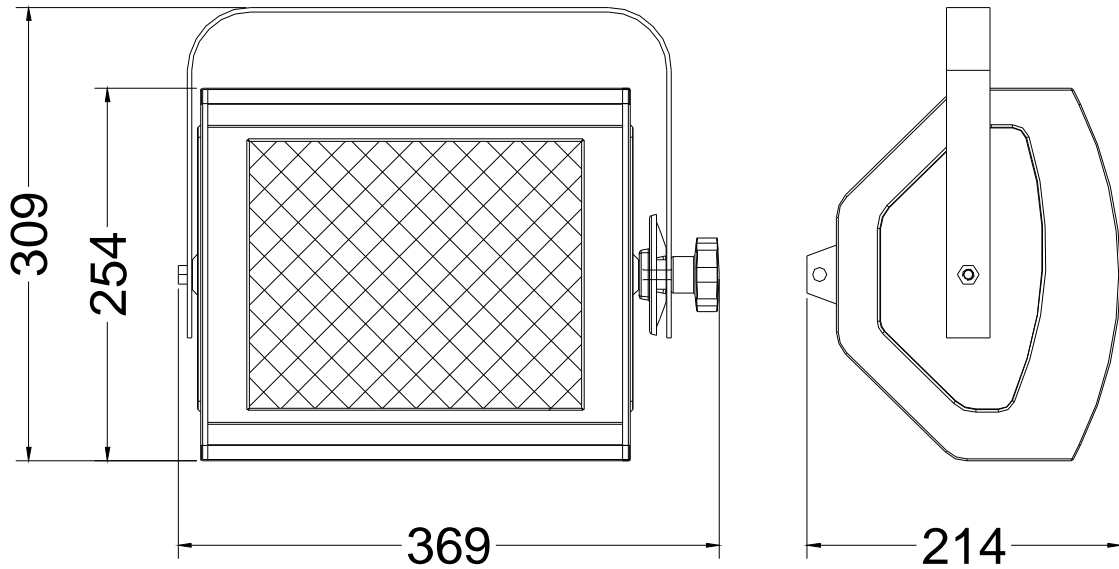

WEIGHT: 3.7kg.